

# FRI

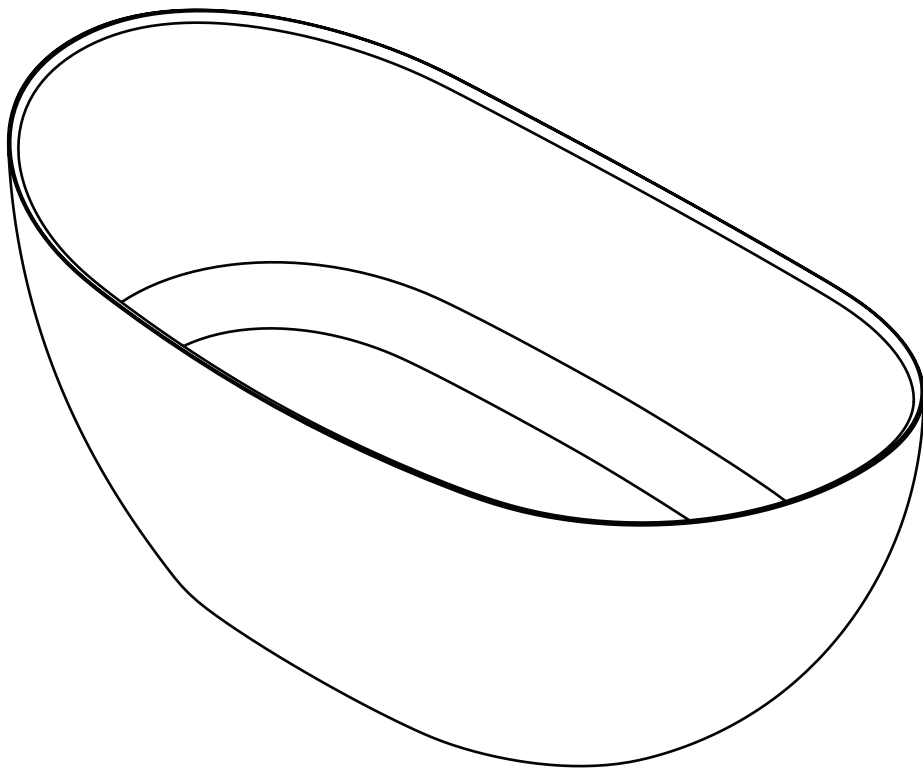

bathlife®

OF SWEDEN



Copyright ©2020 Bygghemma Sverige AB. Original content rights reserved. All product names, logos, and brands are property of their respective owners.



Information contained within this document was considered accurate at the time of publication, but may be subject to revision.



EN **TABLE OF CONTENTS**  
SV **INNEHÅLLSFÖRTECKNING**  
NO **INNHOLDSFORTEGNELSE**  
DK **INDHOLDFORTEGNELSE**  
FI **SISÄLLYSLUETTELO**

<b>Maintenance/skötsel/vedlikehold/vedligeholdelse/hoito</b>	<b>3</b>
<b>Connection/anslutning/forbindelse/yhteys</b>	<b>4</b>
<b>Tools/verktyg/verktøy/værktøjer/työkalut</b>	<b>5</b>
<b>Components/komponenter/komponentit</b>	<b>6</b>
<b>Assembly/montering/montage/kokoonpano</b>	<b>7</b>



Copyright ©2020 Bygghemma Sverige AB. Original content rights reserved. All product names, logos, and brands are property of their respective owners.



Information contained within this document was considered accurate at the time of publication, but may be subject to revision.



- EN **If you have questions**, please contact us.  
 SV **Om du har frågor**, vänligen kontakta oss.  
 NO **Hvis du har spørsmål**, om produktet eller manualen.  
 DK **Hvis du har spørgsmål**, til dette produkt eller manual.  
 FI **Jos sinulla on kysyttävää**, ota yhteyttä.



- EN **If any part is broken**, do not use the product before repairing it.  
 SV **Om någon del är defekt**, åtgärda detta innan produkten brukas.  
 NO **Hvis noen del er ødelagt**, ikke bruke produktet før reparasjoner.  
 DK **Hvis nogen del er brudt**, ikke bruge produktet før du reparerer det.  
 FI **Jos jokin osa on rikki**, älä käytä tuotetta ennen sen korjaamista.



- EN **When cleaning**, do not use bleaching or abrasive chemicals.  
 SV **Vid rengöring**, använd inte blekande eller slipande kemikalier.  
 NO **Ved rengjøring**, ikke bruk blekemidler eller slitende kjemikalier.  
 DK **Ved rengøring**, brug ikke blegemidler eller slibende kemikalier.  
 FI **Kun puhdistat**, älä käytä valkaisu- tai hankaavia kemikaaleja.



- EN Wet surfaces slippery  
 SV Våta ytor halkiga  
 NO våte overflater glatte  
 DK våde overflader glatte  
 FI Märkä pinta liukas



- EN Do not overheat water  
 SV Överhettat ej vattnet  
 NO Ikke overopphetende vann  
 DK Overophed ikke vand  
 FI Älä ylikuumentaa vettä



- EN Notice height differences  
 SV Tänk på höjdskillnader  
 NO Tenk på høydeforskjeller  
 DK Tænk på højdeforskelle  
 FI Ajattele korkeuseroja



- EN Notice pinching risks  
 SV Tänk på klämrisiker  
 NO Tenk på klemt risiko  
 DK Tænk på at klemme risici  
 FI Ajattele riskien puristamista



- EN Keep carton indoors  
 SV Förvara lådan inomhus  
 NO Hold boksen innendørs  
 DK Hold kassen indendørs  
 FI Pidä laatikko sisätiloissa



Copyright ©2020 Bygghemma Sverige AB. Original content rights reserved. All product names, logos, and brands are property of their respective owners.



Information contained within this document was considered accurate at the time of publication, but may be subject to revision.



- EN **Hire licensed professionals** when appropriate.  
 SV **Anlita licensierade hantverkare** när så krävs.  
 NO **Leie lisensierte lisensierte fagfolk** når det er nødvendig.  
 DK **Leje licenserede autoriserede fagfolk** når det kræves.  
 FI **Vuokra llisenoidut ammattilaiset** tarvittaessa.



- EN **Do not use/maintain with dirty water.** Filter when necessary.  
 SV **Använd/underhåll inte med smutsigt vatten.** Filtrera vid behov.  
 NO **Ikke bruk/vedlikehold med skittent vann.** Filter når nødvendig.  
 DK **Icke brug/vedligehold med snavset vand.** Filtrer når nødvendigt.  
 FI **Älä käytä/säilytä likaa vettä.** Suodata tarvittaessa.



**MAX** 60 °C

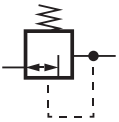

**MAX** 800 kPa (8.0 bar)  
**MIN** 230 kPa (2.3 bar)



Copyright ©2020 Bygghemma Sverige AB. Original content rights reserved. All product names, logos, and brands are property of their respective owners.



Information contained within this document was considered accurate at the time of publication, but may be subject to revision.



**EN** Spirit-level  
**SV** Vattenpass  
**NO** Vaterpass  
**DK** Vaterpas  
**FI** Vatupassi

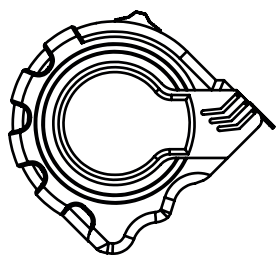
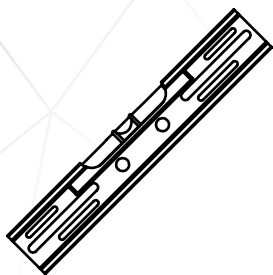

**EN** Measure tape  
**SV** Måttband  
**NO** Måletape  
**DK** Målebånd  
**FI** Iskuporakone

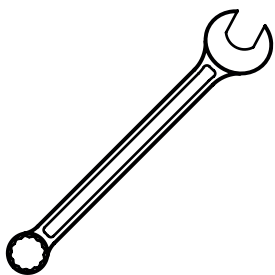

**EN** Spanner  
**SV** Skruvnyckel  
**NO** Skiftenøkkel  
**DK** Skruenøgle  
**FI** Ruuviavain

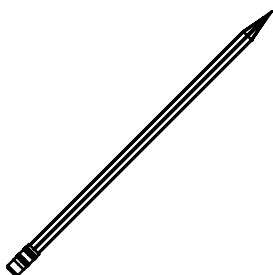

Pen/penn/penna/  
 kynä



Copyright ©2020 Bygghemma Sverige AB. Original content rights reserved. All product names, logos, and brands are property of their respective owners.



Information contained within this document was considered accurate at the time of publication, but may be subject to revision.



01

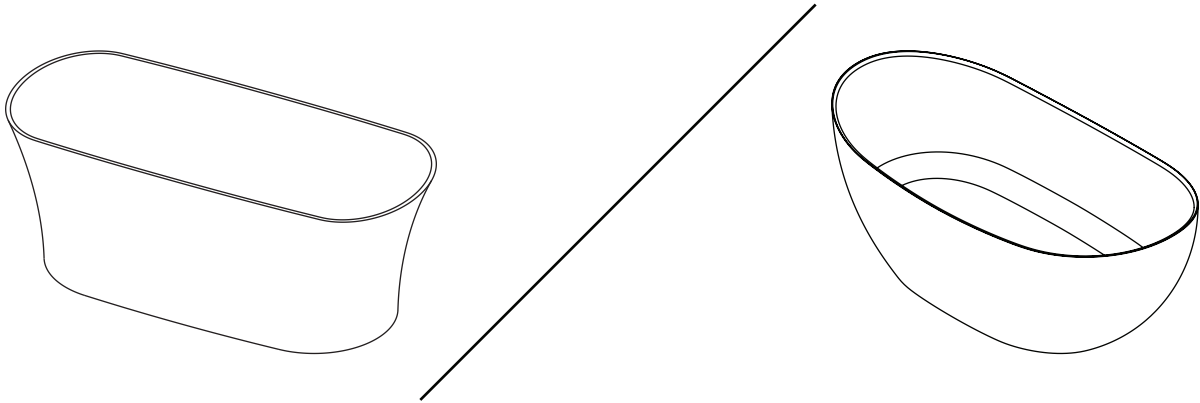

02

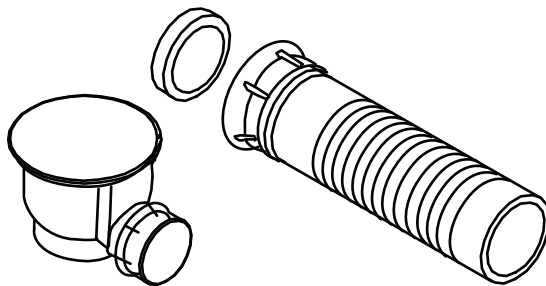

Copyright ©2020 Bygghemma Sverige AB. Original content rights reserved. All product names, logos, and brands are property of their respective owners.



Information contained within this document was considered accurate at the time of publication, but may be subject to revision.



1

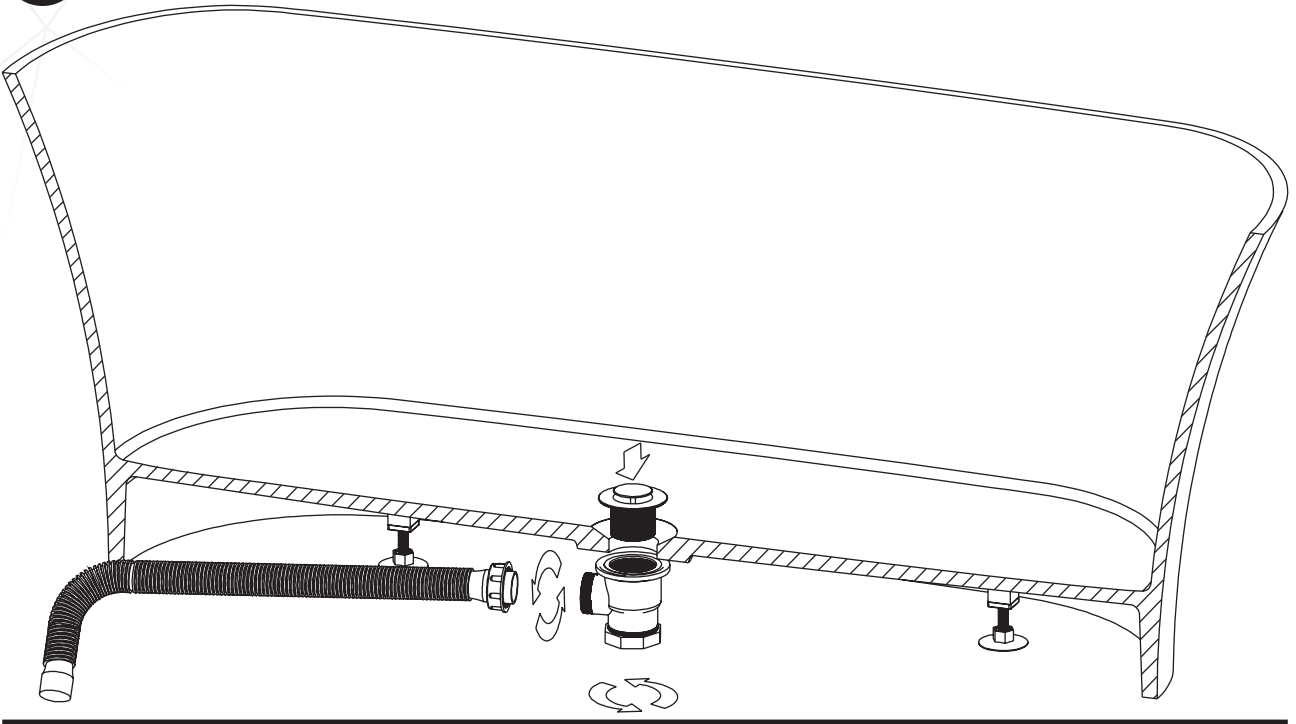

2

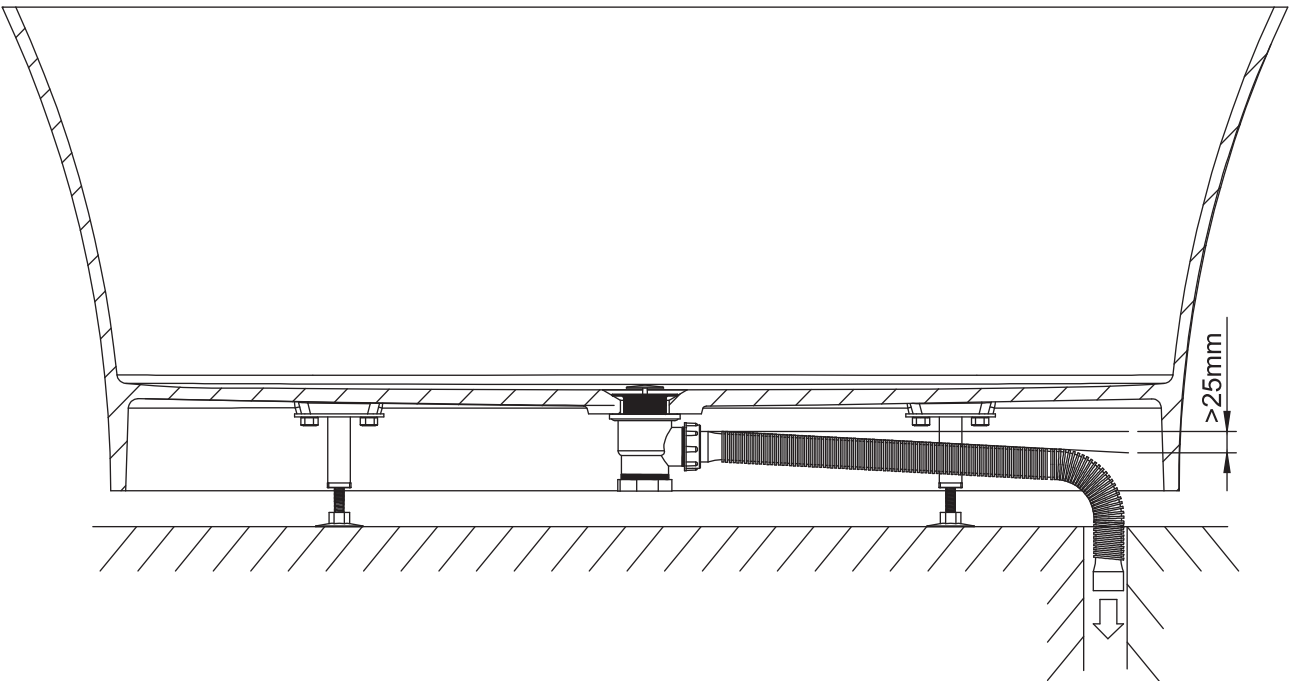

Copyright ©2020 Bygghemma Sverige AB. Original content rights reserved. All product names, logos, and brands are property of their respective owners.



Information contained within this document was considered accurate at the time of publication, but may be subject to revision.

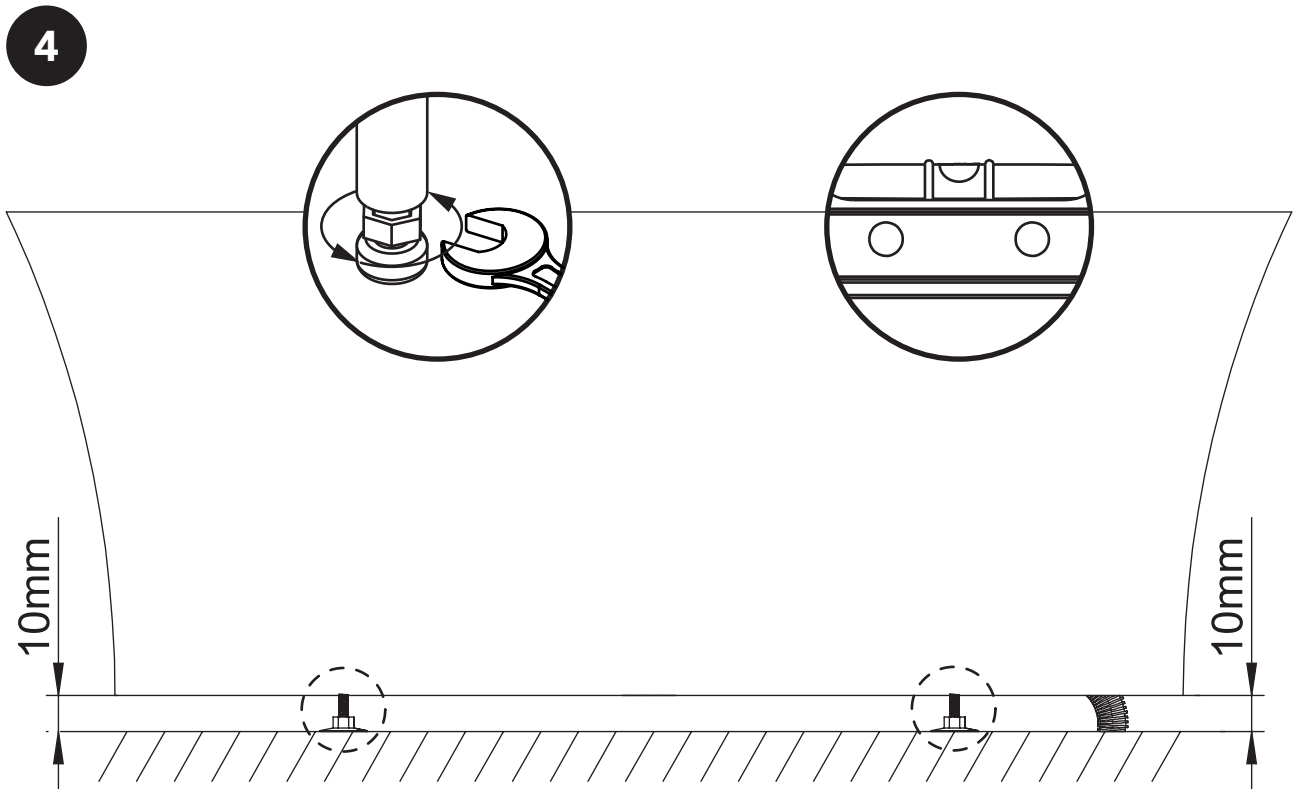
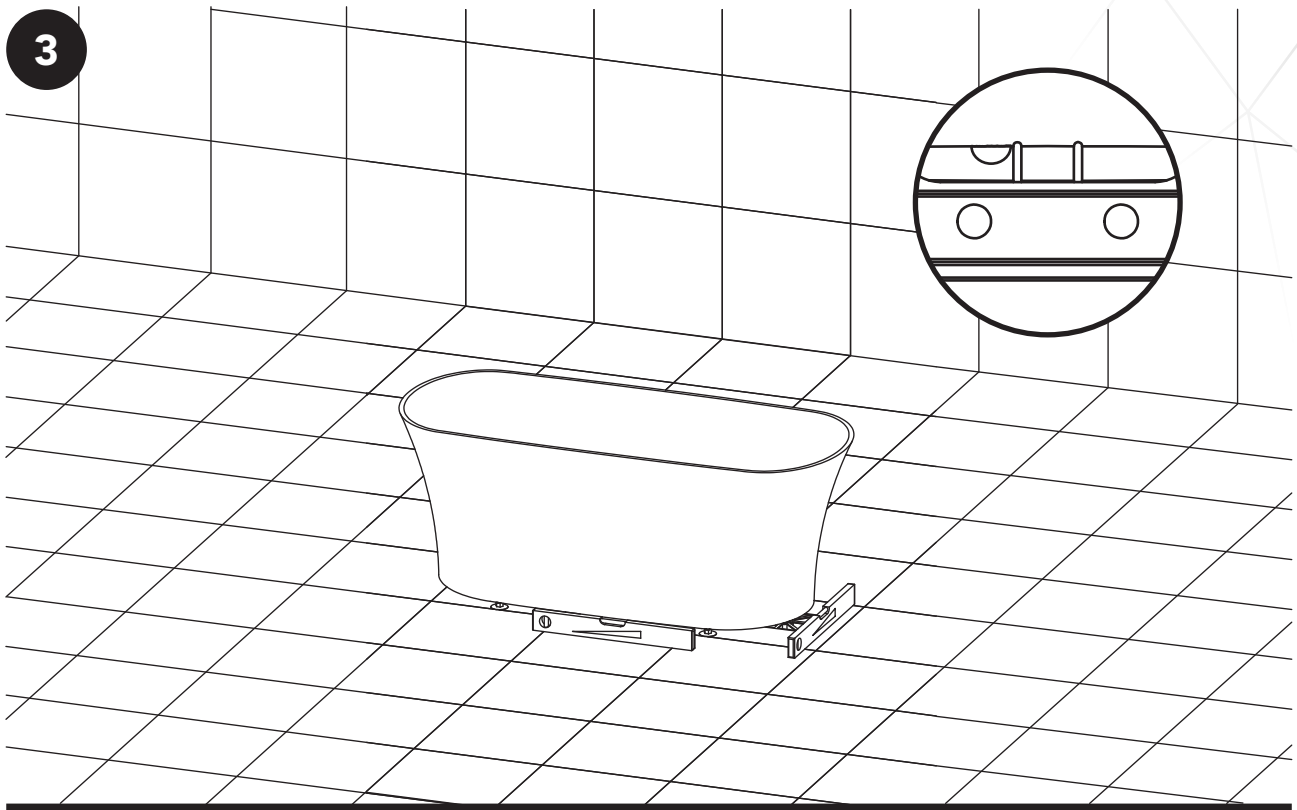

Copyright ©2020 Bygghemma Sverige AB. Original content rights reserved. All product names, logos, and brands are property of their respective owners.



Information contained within this document was considered accurate at the time of publication, but may be subject to revision.